

SEM-FAST ACCESSORIES

- ▶ Conical sealing on corrugated tube
- ▶ Thread sealing by sealing bars
- ▶ Special click-in system, easy and tight assembly

- ▶ konische Abdichtung am Wellenschlauch
- ▶ Gewindeabdichtung mit Dichtleisten
- ▶ spezielles Klicksystem, einfache und feste Montage



- **Product family:** Accessories
- **Construction:** PA injected parts
- **Temperature of use:** up to -40/120°C
- **Standard colors:** black, gray
- **Packaging:** cardboard boxes
- Compatible with POLYFLEX convoluted tubing range. Please contact your Sales Representative for more information.

- **Produktfamilie:** Zubehör
- **Konstruktion:** PA-Spritzgussteile
- **Betriebstemperatur:** bis -40/120°C
- **Standardfarbe:** schwarz, grau
- **Lieferformen:** Karton
- kompatibel mit POLYFLEX-Wellenschläuchen; für weitere Informationen kontaktieren Sie bitte Ihren Vertriebsmitarbeiter.



SEM-Fast Straight & 90°Elbow (black)
UR File E81472 (acc. to UL1696)

DIMENSIONS SEM-FAST STRAIGHT / ABMESSUNGEN SEM-FAST GERADE

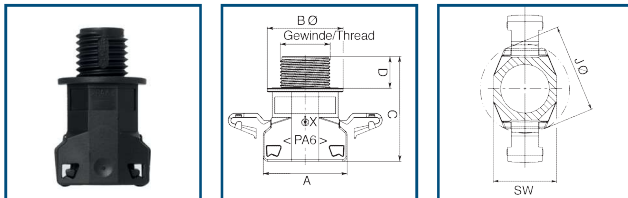

External thread Außengewinde	for Diameter für Durchmesser	SW (mm)	A (mm)	B Ø (mm)	C (mm)	D (mm)	smallest l Ø (mm)	J Ø (mm)	Schlemmer PN (black)	Schlemmer PN (gray)
PG										
PG 7	7.5	14.0	19.0	18.0	34.0	11.0	7.5	21.0	3805028	3805128
PG 7	8.5	16.0	20.6	20.0	35.0	11.0	7.5	23.0	3805012	3805112
PG 7	10	17.0	21.6	22.0	36.0	12.0	9.0	24.5	3805024	3805124
PG 9	10	17.0	21.6	22.0	36.0	12.0	11.0	24.5	3805004	3805104
PG 9	12+13	20.0	25.5	25.0	38.0	12.0	11.0	29.0	3805037	3805137
PG 11	10	17.0	21.6	22.0	36.0	12.0	12.5	24.5	3805050	3805150
PG 11	12+13	20.0	25.5	25.0	38.0	12.0	14.5	29.0	3805009	3805109
PG 13.5	10	17.0	21.6	25.0	36.0	12.0	12.5	24.5	3805064	-
PG 13.5	12+13	20.0	25.5	25.0	38.0	12.0	15.2	29.0	3805010	3805110
PG 13.5	17	27.0	34.5	31.0	43.0	13.0	15.4	38.5	3805005	3805105
PG 16	17	27.0	34.5	31.0	43.0	13.0	18.1	38.5	3805006	3805106
PG 21	22	32.0	40.5	36.0	48.0	13.0	23.0	45.5	3805023	3805123
PG 21	23	34.0	42.5	38.0	48.0	13.0	23.0	48.5	3805014	3805114
PG 29	29	41.0	49.5	46.0	52.0	15.0	31.0	55.5	3805016	3805116
PG 36	37	50.0	59.0	55.0	62.0	17.0	39.0	66.5	3805018	3805118
PG 48	50	64.0	72.0	72.0	68.0	19.0	47.0	80.0	3805021	3805121

External thread Außengewinde	for Diameter für Durchmesser	SW (mm)	A (mm)	B Ø (mm)	C (mm)	D (mm)	smallest l Ø (mm)	J Ø (mm)	Schlemmer PN (black)	Schlemmer PN (gray)
METRIC / METRISCH										
M 12 X 1.5	7.5	14.0	19.0	18.0	34.0	11.0	7.5	21.0	3805047	3805147
M 12 X 1.5	8.5	16.0	20.6	20.0	35.0	11.0	7.5	23.0	3805011	3805111
M 12 X 1.5	10	17.0	21.6	22.0	36.0	12.0	7.5	24.5	3805000	3805100
M 16 X 1.5	10	17.0	21.6	22.0	36.0	12.0	11.0	24.5	3805001	3805101
M 16 X 1.5	12+13	20.0	25.5	25.0	38.0	12.0	11.0	29.0	3805007	3805107
M 20 X 1.5	10	17.0	21.6	25.0	36.0	12.0	12.5	24.5	3805051	-
M 20 X 1.5	12+13	20.0	25.5	25.0	38.0	12.0	15.2	29.0	3805008	3805108
M 20 X 1.5	17	27.0	34.5	31.0	43.0	13.0	15.4	38.5	3805002	3805102
M 25 X 1.5	17	27.0	34.5	31.0	43.0	13.0	19.1	38.5	3805003	3805103
M 25 X 1.5	22	32.0	40.5	36.0	48.0	13.0	19.1	45.5	3805022	3805122
M 25 X 1.5	23	34.0	42.5	38.0	48.0	13.0	19.1	48.5	3805013	3805113
M 32 X 1.5	29	41.0	49.5	46.0	52.0	15.0	25.5	55.5	3805015	3805115
M 40 X 1.5	37	50.0	59.0	55.0	62.0	17.0	34.0	66.5	3805017	3805117
M 50 X 1.5	50	64.0	72.0	72.0	68.0	19.0	43.5	80.0	3805019	3805119
M 63 X 1.5	50	64.0	72.0	72.0	68.0	19.0	47.0	80.0	3805020	3805120
NPT										
NPT 1/4"	7.5	14.0	19.0	18.0	34.0	11.0	7.5	21.0	3805540	-
NPT 1/4"	10	17.0	21.6	22.0	36.0	12.0	7.5	24.5	3805541	-
NPT 3/8"	10	17.0	21.6	22.0	36.0	12.0	11.0	24.5	3805542	-
NPT 3/8"	12+13	20.0	25.5	25.0	38.0	12.0	11.0	29.0	3805543	-
NPT 1/2"	12+13	20.0	25.5	25.0	38.0	12.0	14.5	29.0	3805544	-
NPT 1/2"	17	27.0	34.5	31.0	43.0	13.0	14.5	38.5	3805545	-
NPT 3/4"	23	34.0	42.5	38.0	48.0	13.0	19.1	48.5	3805546	-
NPT 1"	29	41.0	49.5	46.0	52.0	15.0	25.5	55.5	3805548	-
NPT 1 1/2"	50	64.0	72.0	72.0	68.0	19.0	39.0	80.0	3805552	-
NPT 2"	50	64.0	72.0	72.0	68.0	19.0	51.5	80.0	3805553	-

DIMENSIONS SEM-FAST 90° ELBOW / ABMESSUNGEN 90° ELLBOGEN

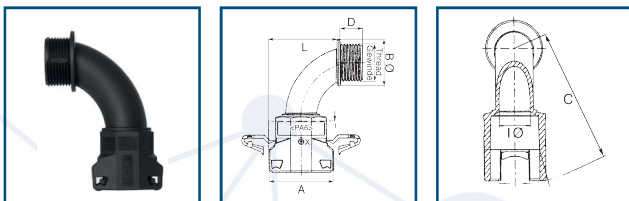

External thread Außengewinde	for Diameter für Durchmesser	A (mm)	B Ø (mm)	C (mm)	D (mm)	smallest l Ø (mm)	L (mm)	Schlemmer PN (black)	Schlemmer PN (gray)
PG									
PG 9	10	21.6	20.0	50.0	12.0	9.5	29.0	3805201	3805301
PG 11	12 + 13	25.5	25.0	54.6	12.0	13.5	34.0	3805207	3805307
PG 13.5	17	34.5	25.0	59.7	12.0	13.5	38.5	3805214	3805314
PG 16	17	34.5	31.0	65.8	13.0	17.0	44.5	3805213	3805313
PG 21	23	42.5	38.0	74.1	13.0	23.0	51.5	3805219	3805319
PG 29	29	49.5	48.0	86.8	15.0	31.0	63.5	3805225	3805325
PG 36	37	59.0	58.0	104.8	17.0	39.5	74.5	3805231	3805331
PG 48	50	72.0	72.0	129.0	19.0	51.5	99.8	3805237	3805337

External thread Außengewinde	for Diameter für Durchmesser	A (mm)	B Ø (mm)	C (mm)	D (mm)	smallest l Ø (mm)	L (mm)	Schlemmer PN (black)	Schlemmer PN (gray)
METRIC / METRISCH									
M 16 X 1.5	10	21.6	20.0	50.0	12.0	9.5	29.0	3805200	3805300
M 16 X 1.5	12 + 13	25.5	20.0	52.7	12.0	9.5	30.5	3805205	3805305
M 20 X 1.5	12 + 13	25.5	25.0	54.6	12.0	13.5	34.0	3805206	3805306
M 20 X 1.5	17	34.5	25.0	59.7	12.0	13.5	38.5	3805211	3805311
M 25 X 1.5	17	34.5	31.0	65.8	13.0	17.0	44.5	3805212	3805312
M 25 X 1.5	23	42.5	31.0	71.3	13.0	17.0	48.5	3805217	3805317
M 32 X 1.5	23	42.5	38.0	74.1	13.0	23.0	51.5	3805218	3805318
M 32 X 1.5	29	49.5	38.0	77.2	13.0	23.0	54.5	3805223	3805323
M 40 X 1.5	29	49.5	48.0	86.8	15.0	31.0	63.5	3805224	3805324
M 40 X 1.5	37	59.0	48.0	95.6	15.0	31.0	68.5	3805229	3805329
M 50 X 1.5	37	59.0	58.0	104.8	17.0	39.5	74.5	3805230	3805330
M 50 X 1.5	50	72.0	58.0	111.2	17.0	39.5	81.0	3805235	3805335
M 63 X 1.5	50	72.0	72.0	129.0	19.0	51.5	99.8	3805236	3805336
NPT									
NPT 1/2"	12+13	25.5	25.0	54.6	12.0	13.5	34.0	3805753	-
NPT 1/2"	17	34.5	35.0	59.7	12.0	13.5	38.5	3805754	-
NPT 3/4"	23	42.5	31.0	71.3	13.0	17.0	48.5	3805755	-
NPT 1"	29	49.5	38.0	77.2	13.0	31.0	54.5	3805756	-
NPT 2"	50	72.0	72.0	129.0	19.0	51.5	99.8	3805760	-

DIMENSIONS SEM-FAST COMBI / ABMESSUNGEN SEM-FAST KOMBI

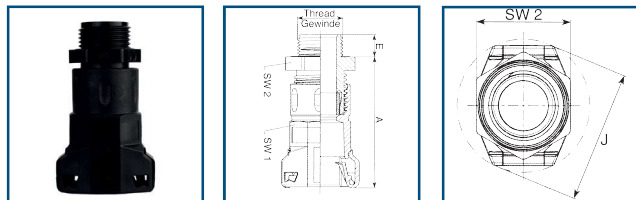

External thread Außengewinde	suitable for corrugated tube NW passend für Wellenschlauch NW	Clamping range (mm) Klemmbereich (mm)	SW 1 (mm)	SW 2 (mm)	E (mm)	A (mm)	J (mm)	Schlemmer PN (black)
PG								
PG 9	10	2.5 - 8.0	17.0	19.0	8.0	47.0	24.5	3805601
PG 11	12+13	3.5 - 10.0	20.0	22.0	8.0	53.0	29.0	3805602
PG 13.5	12+13	5.0 - 12.0	20.0	24.0	9.0	53.0	29.0	3805603
PG 13.5	17	5.0 - 12.0	27.0	24.0	9.0	58.5	38.5	3805604
PG 16	17	7.0 - 14.0	27.0	27.0	10.0	58.5	38.5	3805605
PG 21	22	9.0 - 18.0	32.0	33.0	11.0	68.5	45.5	3805606
PG 21	23	9.0 - 18.0	34.0	33.0	11.0	68.5	48.5	3805607
PG 29	29	14.0 - 25.0	41.0	42.0	11.0	75.0	55.5	3805608

External thread Außengewinde	suitable for corrugated tube NW passend für Wellenschlauch NW	Clamping range (mm) Klemmbereich (mm)	SW 1 (mm)	SW 2 (mm)	E (mm)	A (mm)	J (mm)	Schlemmer PN (black)
METRIC / METRISCH								
M 16X1.5/9	10	2.5 - 8.0	17.0	19.0	8.0	47.0	24.5	3805621
M 16X1.5/11	12+13	3.5 - 10.0	20.0	22.0	10.0	53.0	29.0	3805622
M 20X1.5/13	12+13	5.0 - 12.0	20.0	24.0	10.0	53.0	29.0	3805623
M 20X1.5/13	17	5.0 - 12.0	27.0	24.0	10.0	58.5	38.5	3805624
M 20X1.5/16	17	7.0 - 14.0	27.0	27.0	10.0	58.5	38.5	3805625
M 25X1.5/16	17	7.0 - 14.0	27.0	27.0	10.0	58.5	38.5	3805626
M 25X1.5/21	22	9.0 - 18.0	32.0	33.0	10.0	68.5	45.5	3805627
M 25X1.5/21	23	9.0 - 18.0	34.0	33.0	10.0	68.5	48.5	3805628
M 32X1.5	29	14.0 - 25.0	41.0	42.0	10.0	75.0	55.5	3805629

DIMENSIONS O-RING SEALINGS / ABMESSUNGEN O-RING-DICHTUNG

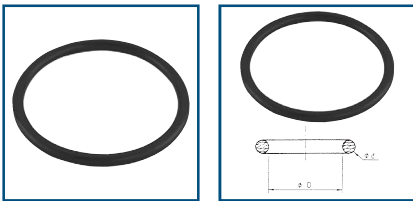

O-Ring sealings are made of NBR70 material
O-Ring-Dichtungen sind aus NBR70-Material

Suitable for profile passend für Profil	Diameter Durchmesser	D (mm)	d (mm)	Schlemmer PN
POLYFLEX NP PA6	7.5	5.0	1.50	8112800
POLYFLEX NP PA6	8.5	7.0	1.20	8112801
POLYFLEX NP PA6	10	7.0	1.50	8112802
POLYFLEX NP PA6	12	9.0	1.50	8112804
POLYFLEX NP PA6	13	8.0	1.60	8112803
POLYFLEX NP PA6	17	14.0	1.78	8112807
POLYFLEX NP PA6	22	14.0	2.00	8112808
POLYFLEX NP PA6	23	18.0	2.00	8112809
POLYFLEX NP PA6	29	20.0	2.50	8112810
POLYFLEX NP PA6	37	24.0	2.50	8112811
POLYFLEX NP PA6	50*	28.0	2.50	8112813

*slip two O-ring sealings for size NW 50 into the first and second groove of the tube
* bei NW 50 schieben Sie zwei O-Ring-Dichtungen jeweils in die erste und zweite Nut des Schlauchs