

# Wellschlauchhalter

RoHS

**Material:**  
Polyamid 6, nach UL94: V2

**Temperaturbereich:**  
-40°C bis 120°C  
kurzzeitig: 150°C

**Farbe(n)/Ausführungen:**

- Schwarz
- Grau

**Eigenschaften:**

- anreihbar
- stapelbar
- für schnelle, einfache, sichere Montage

# Corrugated Tube Holder

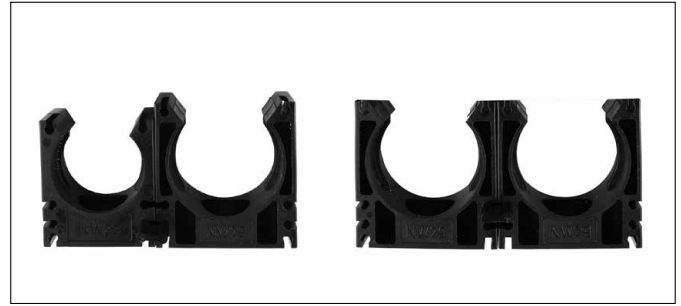

- Rippenfixierung zur Zugentlastung
- Wellschlauch im Halter um die eigene Achse drehbar
- halogenfrei

**Anwendungsbereiche:**

- Maschinen- und Apparatebau
- Roboterbau
- Kraftfahrzeugbau
- Bahntechnik

**Material:**  
Polyamid 6, V2 accord. to UL94

**Temperature range:**  
-40°C to 120°C  
short-term: 150°C

**Colour(s)/Designs:**

- Black
- Grey

**Characteristics:**

- for series mounting
- stackable

- for quick, easy and safe mounting
- rib fixation as traction relief
- corrugated tube is twistable around its own axis
- free of halogen

**Applications:**

- mechanical engineering and facility constructions
- robot engineering
- automotive industry
- railway engineering

## Wellschlauchhalter ohne Deckel / Corrugated Tube Holder no cap

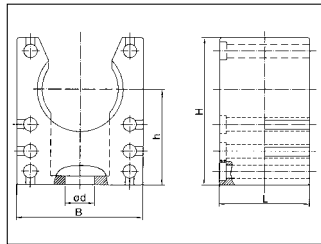

für NW for NW	B mm B mm	H mm H mm	h mm h mm	L mm L mm	d mm d mm	Art.-Nr. schwarz Art. no. black	Art.-Nr. grau Art. no. grey	VE Stck. PU pcs.
7,5	20,0	18,0	12,0	20,0	4,2	8221050	8221150	100
10	20,0	23,0	15,5	20,0	5,5	8221051	8221151	100
12+13	22,0	26,0	17,1	20,0	5,5	8221052	8221152	50
14+16	28,0	33,0	21,1	20,0	6,5	8221053	8221153	50
17	28,0	33,0	21,4	20,0	6,5	8221054	8221154	50
22	35,0	40,0	24,8	20,0	6,5	8221049	-	50
23	35,0	40,0	24,8	20,0	6,5	8221055	8221155	50
29	43,0	45,0	26,8	20,0	6,5	8221056	8221156	30
37	54,0	53,0	30,8	20,0	6,5	8221057	8221157	20
50	68,0	66,0	37,8	20,0	6,5	8221058	8221158	20

## Deckel für Wellschlauchhalter



## Cap for Corrugated Tube Holder

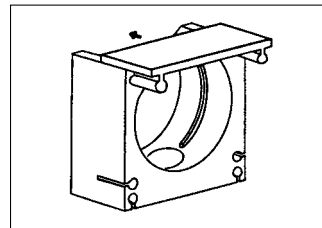

für NW for NW	Art.-Nr. schwarz Art. no. black	Art.-Nr. grau Art. no. grey	VE Stck. PU pcs.
7,5+10	8221250	8221350	100
12+13	8221251	8221351	50
14+16+17	8221252	8221352	50
22+23	8221253	8221353	50
29	8221254	8221354	30
37	8221255	8221355	20
50	8221256	8221356	20

## Verbindungssteg für Wellschlauchhalter

Zum Aneinanderreihen oder Stapeln mehrerer Wellschlauchhalter

## Connecting Piece for Corrugated Tube Holder

To line or staple corrugated tube holders

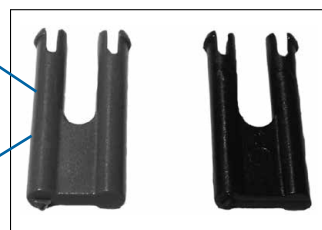
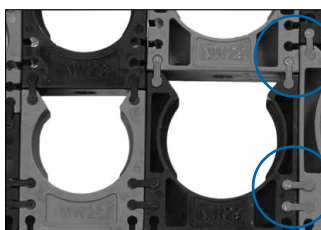

für NW for NW	Art.-Nr. schwarz Art. no. black	Art.-Nr. grau Art. no. grey	VE Stck. PU pcs.
7,5 - 50	8221400	8221401	100