

MOD II Shrouded Headers

Straight, Single Row

Specification:

- Housing** - Black thermoplastic, UL 94V-0 rated
- Posts** - Brass (gold plating) or phosphor bronze (tin plating). Plating details as follows:
- Plating A** - Gold 0.8 µm on contact area and 2.5 µm tin on solder area, with entire post underplated 1.3 µm nickel
- Plating B** - Gold 0.4 µm on contact area and 2.5 µm tin on solder area, with entire post underplated 1.3 µm nickel
- Plating C** - Tin 3.5 µm

Mating Connectors:

- MOD II Receptacle Housings - Page 12
- MOD II PCB Receptacles - Page 14

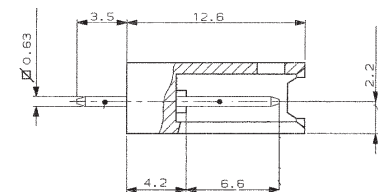
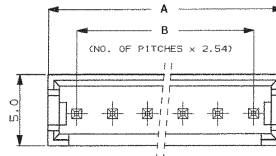

Technical Documents:

Product Specification - 108-20025

No. of Positions	Dimension		Plating A	Part Number	Plating B	Plating C
	A	B				
2	7.7	2.54	280370-3	280370-2	280370-1	
4	12.7	7.62	280371-3	280371-2	280371-1	
6	17.8	12.70	280372-3	280372-2	280372-1	
8	22.9	17.78	280373-3	280373-2	280373-1	
9	25.4	20.32	-	280508-2	280508-1	
10	28.0	22.86	280374-3	280374-2	280374-1	
12	33.1	27.94	280520-3	280520-2	280520-1	
15	40.7	35.56	280375-3	280375-2	280375-1	
22	58.5	53.34	280376-3	280376-2	280376-1	

MOD II Shrouded Headers

Straight, Double Row

Specification:

- Housing** - Black thermoplastic, UL 94V-0 rated
- Posts** - Brass (gold plating) or phosphor bronze (tin plating). Plating details as follows:
- Plating A** - Gold 0.8 µm on contact area and 2.5 µm tin on solder area, with entire post underplated 1.3 µm nickel
- Plating B** - Gold 0.4 µm on contact area and 2.5 µm tin on solder area, with entire post underplated 1.3 µm nickel
- Plating C** - Tin 3.5 µm

Mating Connectors:

- MOD II Receptacle Housings - Page 12
- MOD II PCB Receptacles - Page 14

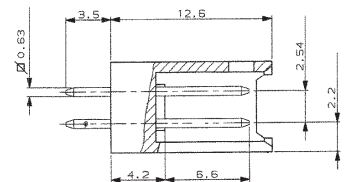
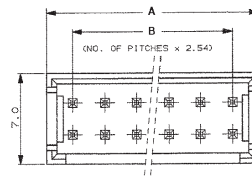

Technical Documents:

Product Specification - 108-20025

No. of Positions	Dimension		Plating A	Part Number	Plating B	Plating C
	A	B				
2x4	12.7	7.62	280384-3	280384-2	280384-1	
2x8	22.9	17.78	280385-3	280385-2	280385-1	
2x9	25.4	20.32	280509-3	280509-2	280509-1	
2x12	33.1	27.94	280521-3	280521-2	280521-1	
2x15	40.7	35.56	280387-3	280387-2	280387-1	
2x18	48.3	43.18	-	281019-2	-	
2x22	58.5	53.34	-	280388-2	280388-1	